

Setup and Printing - Printables Use and Guidance

Printables are intended to be cut and placed into a picture frame. They are often placed into 5x7 inch frames or 8x10 inch frames. Frames are placed on walls, tables, desks, or anywhere that inspires you.

Most people look around their home for frames that they are no longer using or frames that they never used. Many people print out a printable and put it into a frame to accompany the gift that they just purchased.

Printing.

Printables are usually distributed in .pdf format so that they can be used on any computer format. Almost always you will print them using the Adobe Acrobat Reader DC application or a similar Adobe application.

When printing you will need to determine what size frame you are working in and adjust the printing to fit that format.

Below are some examples from a recent version of the free Adobe Acrobat Reader Print selection. If your screen looks different that is because Adobe is constantly updating their applications and they may have moved things around. So take in the concepts below and adjust them to any changes that have happened in your version.

1. Fit the Total Paper Size.
 - a. This sometimes works for 8x10 Size Prints since most paper is 8 ½ x 11 inches. See Example:

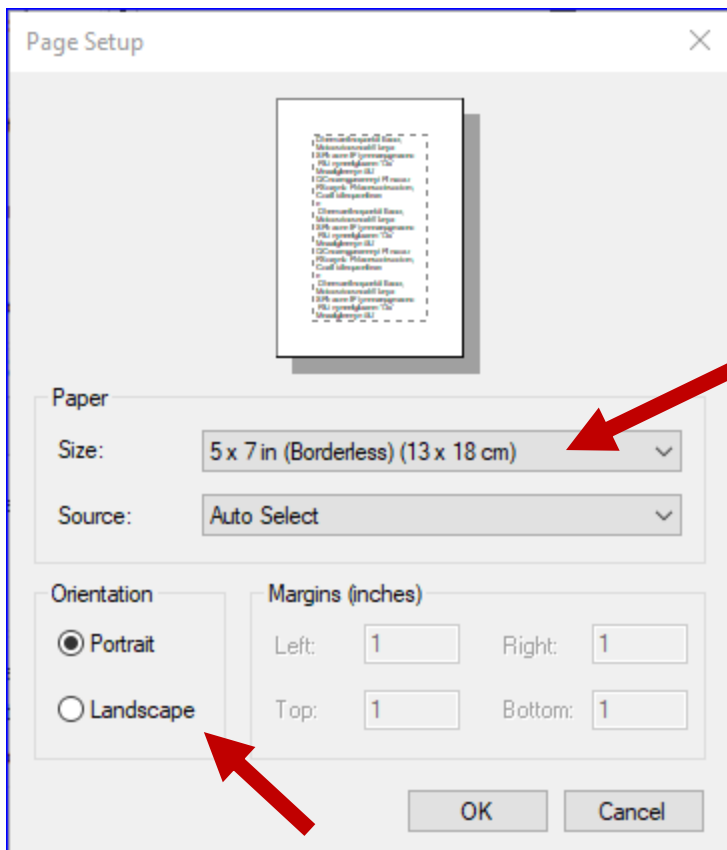

Select the Printing Size you prefer.

This is the Page Setup Button in your options. Please find it and select it. Then choose.

It might be in the very bottom left of Adobe Acrobat Reader

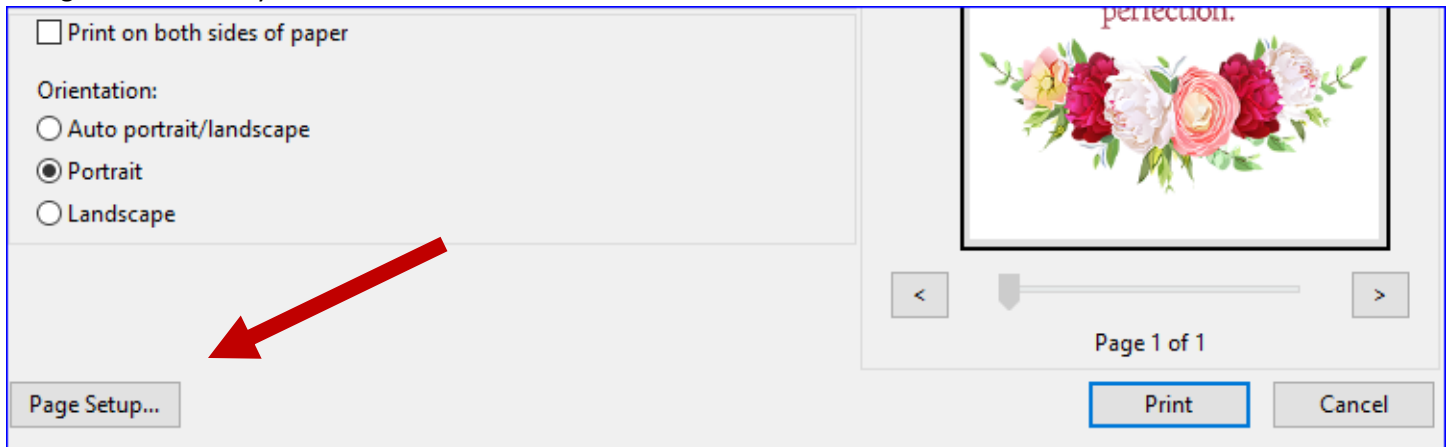

Different Versions and different printers may show this slightly differently so you may need to search but they should all have these options. Always upgrade to the latest if you encounter issues.

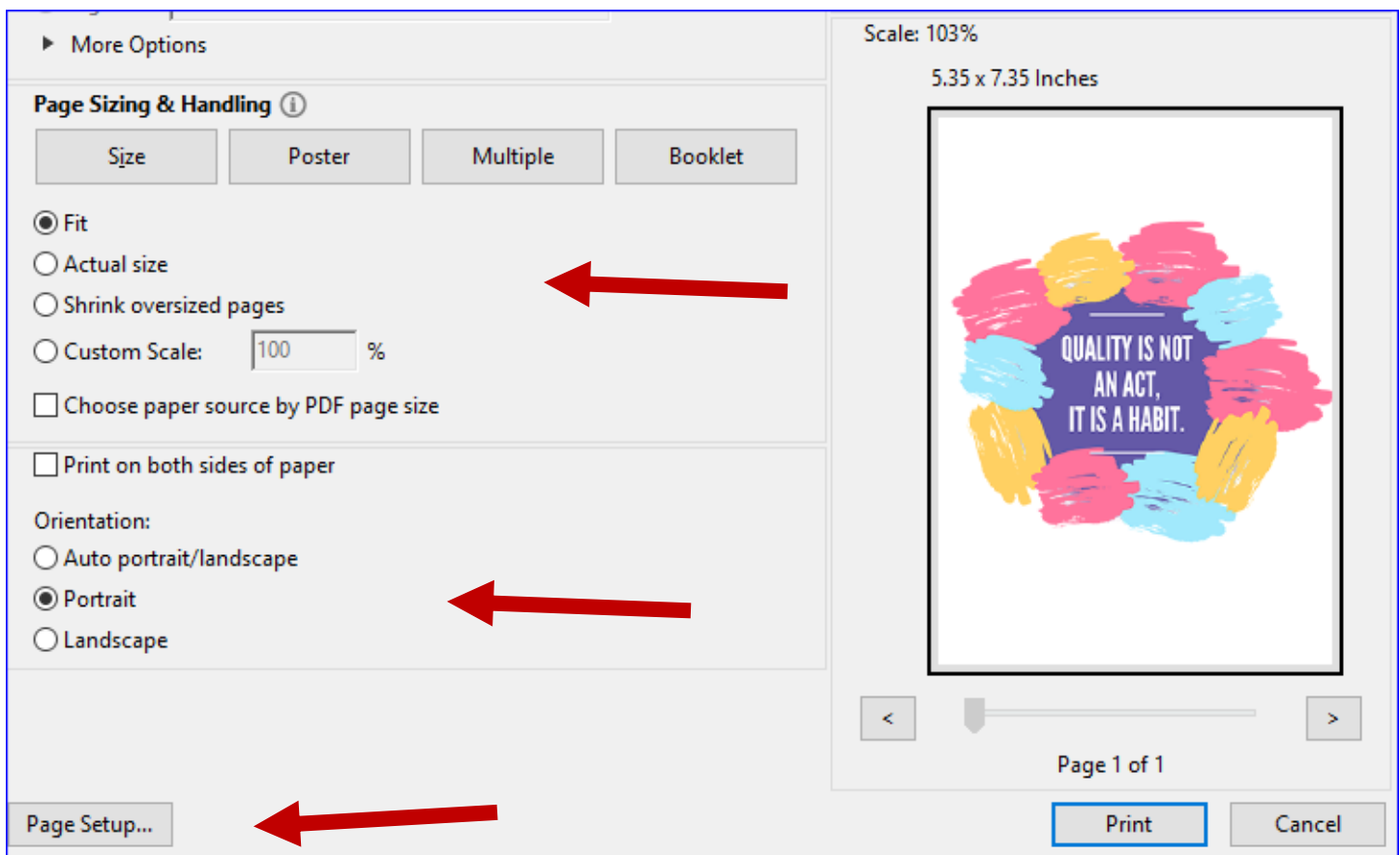

You Should first Adjust your Orientation.

Do you want Portrait or Landscape ? If you want your frame to be on its side, choose Landscape.

Then you will need to decide if you want to fit the page or modify the size to fit your frame area.

Find the correct size for your frame as shown here. This will vary based on your frame size and how you would like to align it.

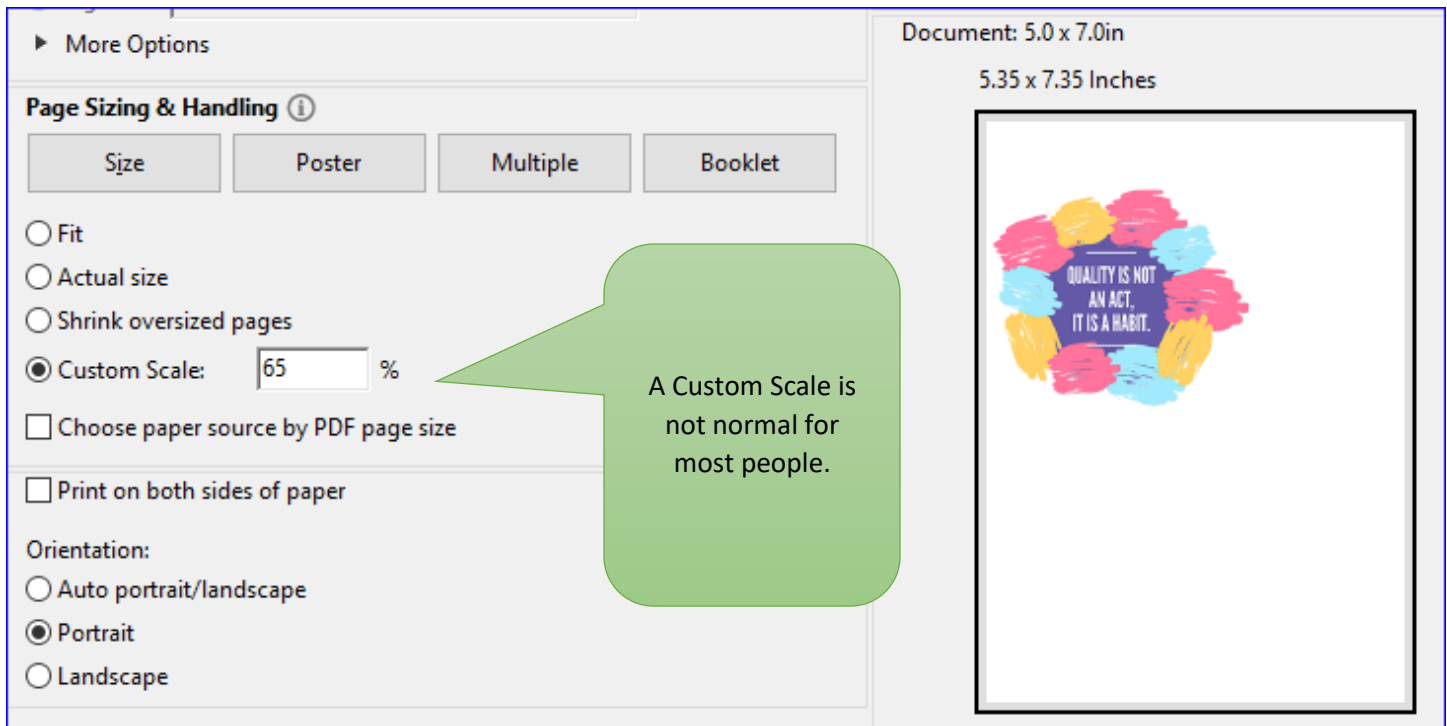

Turn off Saving for this printing only. You should return this to normal after you are finished.



Return this setting to your normal preference after printing. In the example below it is normally in Save ink/toner in this person's environment.



At this point you have observed all of the primary options. You may experiment to create additional effects if you like.

Your Printer Options – Your Printer Software

Your printer may have additional Quality options that you can set. In our example below this is a Brother printer, and it has some additional quality settings that we may choose to use. Your printer may also have similar options that you should explore.



Basic | **Advanced** | Print Profiles | Maintenance

Media Type: Plain Paper (v)
i ☐ Slow Drying Paper

Print Quality: Normal (v)

Paper Size: 5 x 7 in (13 x 18 cm) (v)

i ☒ Borderless

Color Mode: *i* ☒ Natural ☐ Vivid
 

Orientation: ☒ Portrait ☐ Landscape

Copies: 1 (v) ☒ Collate ☒ Reverse Order

Multiple Page: Normal (v)

Page Order: Right, then Down (v)

Border Line: None (v)

2-sided / Booklet: None (v)

2-sided Settings(X)...

Notice the Vivid Color Mode.

If you explore your options from your printer manufacturer, you may find other options to test and use.
Example:

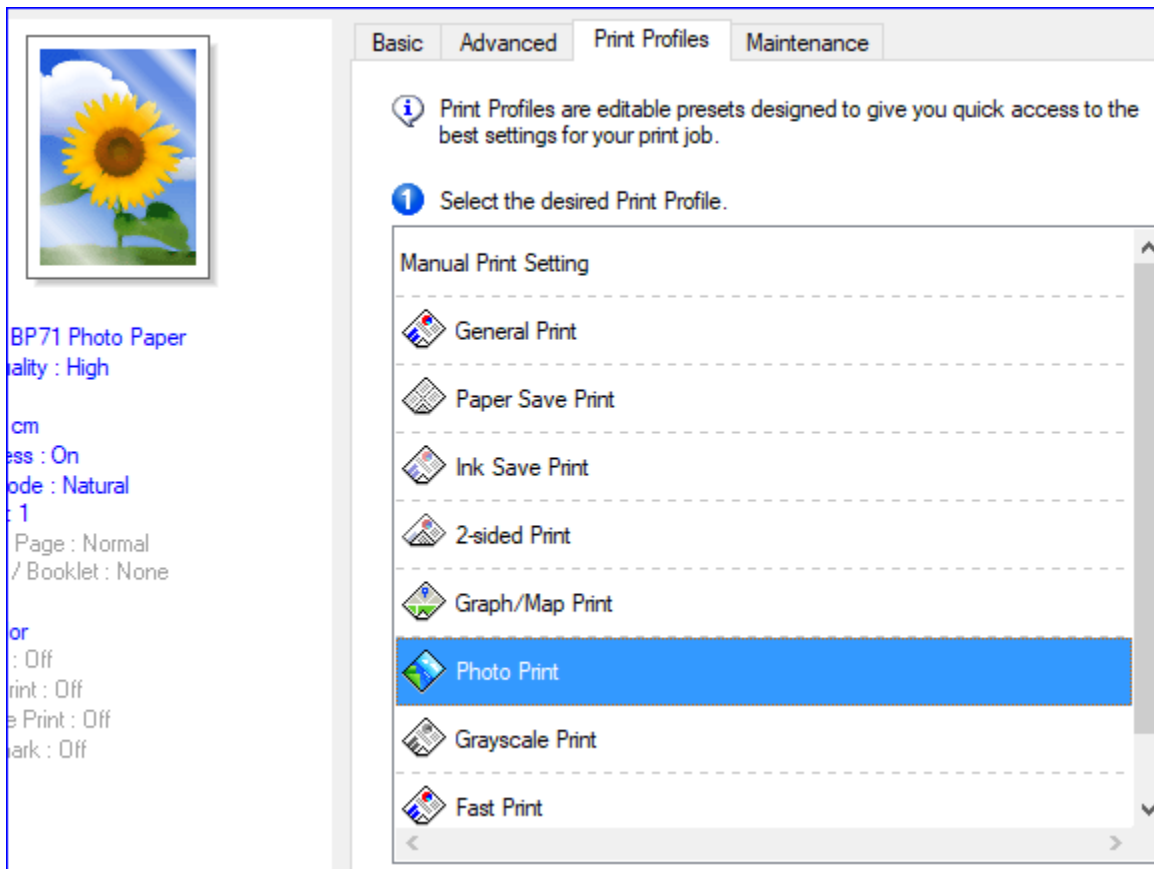

Most of the printables do not need Photo Paper.

Printables, Checklists, Affirmations and Tightly formatted Print Items

Some of the printables may include Checklists, or Affirmations that you will also want to print and frame.

Adjust them to fit your Frame Size or if you want to mount them on Wallboard you have many options. If you are framing Checklists or Affirmations, you may want to carefully check the margins. When framing Affirmations or Checklists it is sometimes more important to be sure alignment is good, because they tend to have solid line edges.

Coloring Books require special attention before you color. If you have a coloring book and intend to frame the item. It is usually best to select the frame size before you print and fit the frame in your Acrobat print selection. Otherwise you may have an 8 ½ x 11 coloring item.

Posters Options

Poster Options in printing are good for Certain uses. Example is a Happy Birthday Sign or collection of Pages. Larger posters created with a set of paper will need to be taped together unless you have a plotter. And you should consider if this is the effect for you.

Finish Up

Don't forget to return all of your settings back to the way they were before you printed, or you and others will likely be both unhappy and confused next time someone prints. Yes this means you should write things down the way they were before you change them.

Enjoy!